

Good evening, We are Mr. and Mrs. Taylor.

Flooding in Field No TAO 335 8605. Site of the converter stations.

Situated on the East and North East boundaries is an area of low lying land of approximately 3 acres. With increasing Climate Change, now in Summer and Winter, after a period of heavy rain of one inch or less, it holds the water from the surrounding fields. It acts as an Attenuation Pond, this helps to prevent flooding towards Cottingham which was badly flooded in July of 2007. It works in a similar way to the several Attenuation Chambers constructed around the local area. My husband, who has farmed here all his working life knows this area has tended to flood each year. Several attempts to drain it were unsuccessful, so it was sown with grass. A plan and photos taken in Nov2019 will be forwarded.

Field No TAO 334 4672

Situated to the South, which is on the Cable Route, has Springs here which rise and flow following similar weather.

Security. Rural crime is on the increase. The straight access road from the A1079 to the Site does not pass any dwellings and could attract unauthorised people.

Fire. We feel the fire risk will increase due to the close proximity of the Converter Stations and other structures. Access for Emergency Vehicles could be difficult. In April 2013 a massive blaze at Creyke Beck sub-station, in which no-one was injured, meant we were not allowed to leave the premises, the ponies panicked and had the wind direction changed, we and the ponies would have had to be evacuated.

The house which is mainly single glazed, the buildings and the surrounding pony paddocks will be subjected to noise, dust, vibration and light pollution. Due to the very close proximity of the converter station construction work, the temporary working area and the cable route the entire area we occupy will be surrounded. Access is required 24/7.

A Vet's Report regarding our ponies' welfare, which is of concern, will be forwarded.

Thank you for allowing us to speak at this meeting.



Search for a postcode or place name



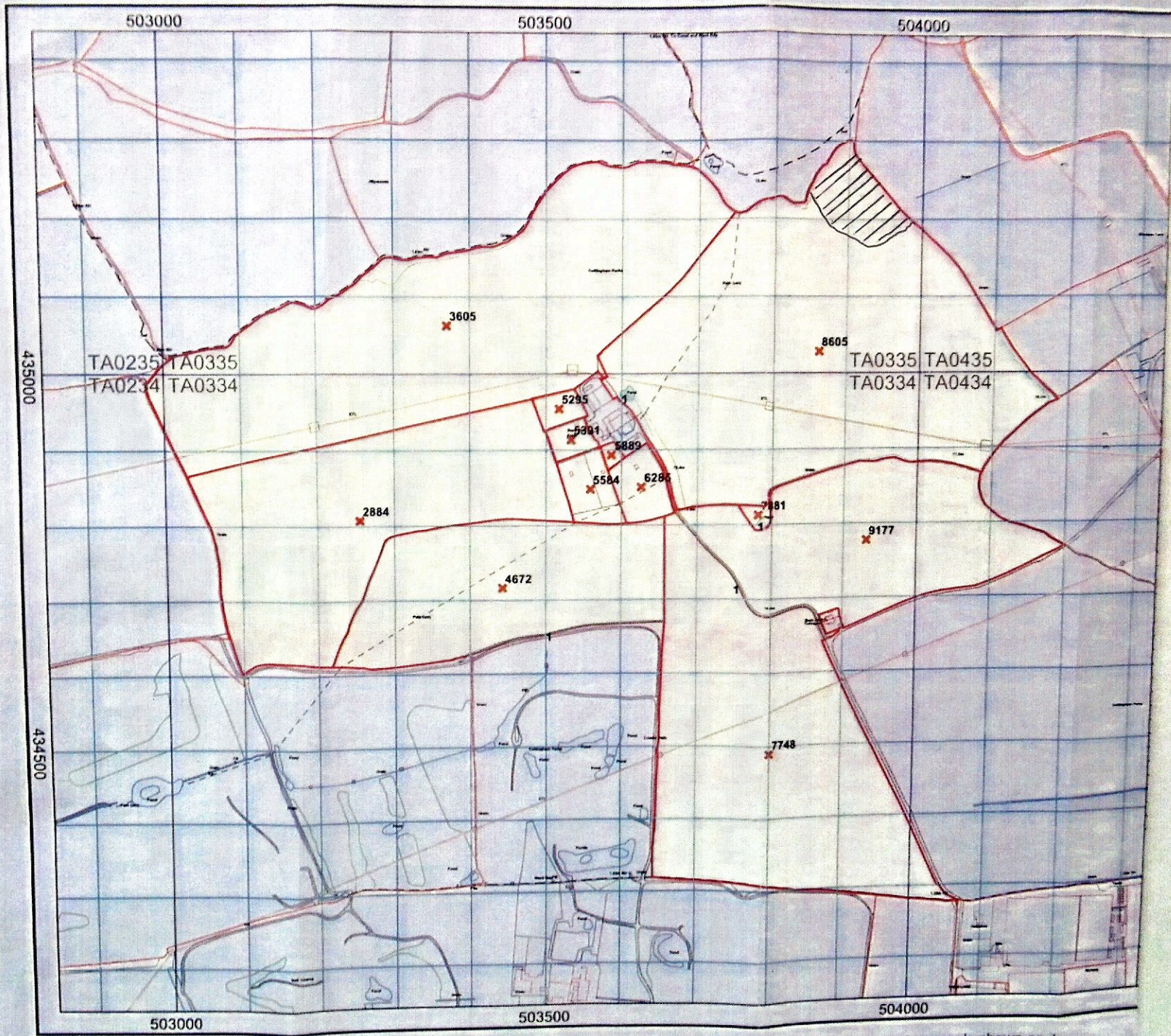

 ATTENUATION
 POND

TA0334
 4672
 SPRINGS



Wicstun Veterinary Group

*The Complete Veterinary Service for
Farm, Equine and Companion Animals*

46, SOUTHGATE, MARKET WEIGHTON, YORK YO43 3BQ

Tel: (01430) 873219 marketweighton@wicstunvets.co.uk
www.wicstunvetgroup.co.uk

N. WATSON, M.A., Vet.M.B., M.R.C.V.S.
J. C. SLEIGH, B.V.M.S., M.R.C.V.S.
J. E. B. HAMILTON, B.V.Sc., Cert.P.M., M.R.C.V.S.
E. B. G. PETTIFER, B.V.M.+S., M.R.C.V.S.
A. J. MOLL, B.VetMed., M.R.C.V.S.

19th September 2019

To whom it may concern,

I am writing in support of Mr & Mrs Taylor of [REDACTED] and their concerns over the proposed development neighbouring their property. They have ponies, some of which have respiratory health problems that could be worsened with the dust and disturbance caused during works. It is likely that the construction phase lasting over a period of years, in such a close vicinity to where the animals are both housed and graze could have a negative impact on the animals welfare.

[REDACTED]

Edward Pettifer

BVM+S PGCert SAS MRCVS